

| ITEM | QTY | DESCRIPTION |
|------|-----|-----------------------------|
| 1 | 1 | Baseplate Assembly |
| 2 | 1 | Torsion Spring |
| 3 | 2 | 1/2" x 3" Aluminum Hex Bolt |
| 4 | 2 | 1/2" Aluminum Hex Nut |
| 5 | 6 | 1/2" Aluminum Washer |
| 6 | 1 | Foam Ring |
| 7 | 1 | Polyethylene Bollard |
| 8 | 1 | 1 5/8" Galvanized Post |
| 9 | 1 | 1 5/8" Shaft Collar |

Flexible Bollard with Signpost Assembly Diagram

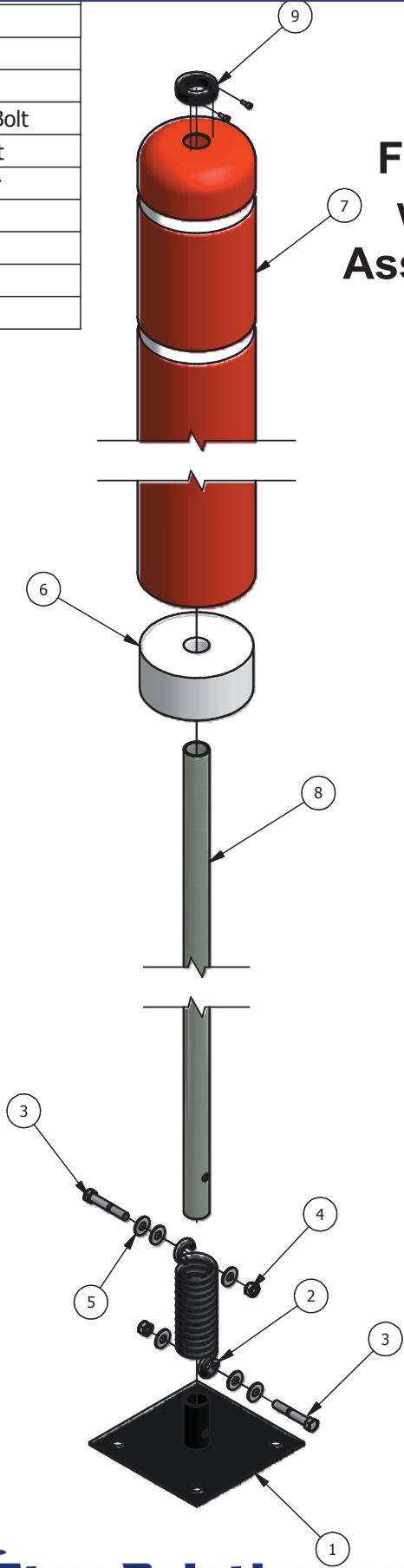

Recommended Use
Parking Lots

Specifications
HRPO Steel Baseplate - Galvanized Steel Pole
Aluminum Shear Away Bolts

Date: 9/8/2007
Size: ANSI A
Sheet 1 of 1

